

Owner Change Order (OCO)



Project Name: Brookline - Driscoll  
School  
Gilbane Project No.: J08864.000

OCO: OCO-0043  
  
PCI: OS-00438, OS-00441  
Alternate Tracking #:

Attention:  
Owner: Town of Brookline  
Address: 333 Washington Street  
  
Brookline, MA 02445 US  
Architect: Jonathan Levi Architects LLC, Mark Warner

Date Issued: 11/05/2024

The Contract changes as follows:  
Scope Of Changes: OCO 43 Misc. Changes  
Description: November Change Order for ATPs 447 and 449

Attachments:

Number	Title	PCI	Change Date	Revision
00000001	<a href="#">ATP-447 RFI 873- Gas Line at Tree Pits-signed.pdf</a>		11/05/2024	
00000002	<a href="#">ATP-449 RFI 866- Exterior Water Line Valves-signed.pdf</a>		11/05/2024	

Job	PCI Code	Phase Code	Description	Subcontractor	Basis	Amount	ATP
J08864.000		01.22A.220000.TC	Plumbing	Patrick J Kennedy & Sons Inc	Final	\$1,601.00	<a href="#">ATP-0449</a>
J08864.000		99.970.950050.Z	Gen & Excess Liability Insurance		Final	\$46.00	<a href="#">ATP-0449</a>
J08864.000		99.970.997000.Z	Performance & Payment Bond		Final	\$10.00	<a href="#">ATP-0449</a>
J08864.000		99.975.996000.Z	Subcontractor Default Insurance		Final	\$.00	<a href="#">ATP-0449</a>

J08864.000		99.999.999000.Z	Fee		Final	\$83.00	<a href="#">ATP-0449</a>
TOTAL FOR PCI No. OS-00438						\$1,740.00	
J08864.000		01.02A.030000.F	Cast-In-Place Concrete	Marguerite Concrete Contractors, Inc	Final	\$ .00	<a href="#">ATP-0447</a>
J08864.000		01.31A.311000.X	Sitework	J. Derenzo Company	Final	\$3,417.00	<a href="#">ATP-0447</a>
J08864.000		99.970.950050.Z	Gen & Excess Liability Insurance		Final	\$98.00	<a href="#">ATP-0447</a>
J08864.000		99.970.997000.Z	Performance & Payment Bond		Final	\$21.00	<a href="#">ATP-0447</a>
J08864.000		99.975.996000.Z	Subcontractor Default Insurance		Final	\$41.00	<a href="#">ATP-0447</a>
J08864.000		99.999.999000.Z	Fee		Final	\$179.00	<a href="#">ATP-0447</a>
TOTAL FOR PCI No. OS-00441						\$3,756.00	
Submitted Amt:						\$5,496.00	

Signature of the Owner indicates agreement herewith, including any adjustment in the Contract Sum or the Contract Time	
The Original Contract price was	\$94,298,030.00
Net change by previously authorized Change Orders	\$7,278,719.20
Contract Price prior to this Change Order	\$101,576,749.20
Contract Price will be changed by this Change Order in the Amount	\$5,496.00
The new Contract Price including this Change Order will be	\$101,582,245.20
The Contract Time will be changed by	0
The date of Substantial Completion for construction as of the date of this Change Order therefore is	08/14/2024

Gilbane Building Company

Gilbane Building Company

Signed: 11/5/2024 3:58:42 PM Eastern Standard Time - By:  
Douglas Murphy (Project Executive )

Gilbane Building Company: 10.129.97.61

Jonathan Levi Architects LLC

DocuSigned by:  
Carol Harris

By: AF1EA2FE13C443D...

Title: Project Manager

Company: Jonathan Levi Architects

Date: 11/6/2024

Printed Name: Carol Harris

LeftField, LLC

DocuSigned by:  
Lynn Stapleton

By: 368F4376FA58451...

Title: OPM

Company: LeftField

Date: 11/5/2024

Printed Name: Lynn Stapleton

Town of Brookline

By:

Title:

Company:

Date:

Printed Name:



Gilbane Building Company  
Authorization To Proceed



CONTRACT FOR: Brookline - Driscoll School  
OWNER: Town of Brookline  
ADDRESS: 333 Washington Street  
Brookline, MA 02445

PROJECT NUMBER: J08864.000  
ATP NO: ATP-0447  
ATP VERSION: 0  
DATE OF ISSUANCE:  
SUBMITTED BY: Gilbane Building Company

ARCHITECT: Jonathan Levi Architects LLC, Mark Warner

ALTERNATE  
TRACKING #:

The Contract Documents are hereby amended to include the additional Work described below, which is outside of the current scope of the Work and constitutes a change.

Upon Owner approval, Gilbane Building Company will proceed with the Work promptly.

Costs as incurred are in addition to the current contract Sum and will be invoiced and paid on a monthly basis and identified as separate items within the requisition. Once final cost of the Work involved and change in Sum and Time (if any) are fully determined, it will be submitted for inclusion in a final Change Order adjusting the Contract Sum and/or Time.

TITLE:RFI 873- Gas Line at Tree Pits

DESCRIPTION:This ATP represents the cost associated with sawcutting the already placed sidewalk, excavating to allow for a new tree pit, and installing the sidewalk in the existing tree pit, per RFI 873. The cost is only for relocating the tree pit at the middle of Westbourne Terrace, and pricing for the other relocated tree pit near the bump out can be provided in a separate ATP if requested by the town.

Attachments:

Number	Description:	PCI Number	Change Date	Revision
00000001	<a href="#">ATP-447 Backup.pdf</a>		10/22/2024	

The Following information is provided by Gilbane Building Company  
Method of determining change in Contract:

- ☐ Guaranteed Maximum Price
- ☐ Cost Plus Fee
- ☐ Unit Price
- ☐ Lump Sum
- ☐ Other

Change In Contract Sum  
Dollar Amount: \$3,756.00

- ☐ Fixed
- ☐ Maximum
- ☐ Estimated
- ☐ Time and Material

Change In Contract Time  
Time (Days): TBD

- ☐ Fixed
- ☐ Maximum
- ☐ Estimated

Job	PCI No.	Description	Phase Code	SubContractor	Amount
-----	---------	-------------	------------	---------------	--------

Job	PCI No.	Description	Phase Code	SubContractor	Amount
J08864.000	OS-00441	Cast-In-Place Concrete	01.02A.030000.F	Marguerite Concrete Contractors, Inc	\$ .00
J08864.000	OS-00441	Sitework	01.31A.311000.X	J. Derenzo Company	\$3,417.00
J08864.000	OS-00441	Gen & Excess Liability Insurance	99.970.950050.Z		\$98.00
J08864.000	OS-00441	Performance & Payment Bond	99.970.997000.Z		\$21.00
J08864.000	OS-00441	Subcontractor Default Insurance	99.975.996000.Z		\$41.00
J08864.000	OS-00441	Fee	99.999.999000.Z		\$179.00
TOTAL FOR PCI No. OS-00441					\$3,756.00

**Submitted Amt:**    \$3,756.00

Gilbane Building Company

Gilbane Building Company

Signed: 10/28/2024 6:02:41 PM Eastern Standard Time - By: Douglas Murphy (Project Executive )

Gilbane Building Company: 10.41.244.181

Jonathan Levi Architects LLC

DocuSigned by:  
Carol Harris

AF1EA2FE45C446D...

By: Project Manager

Title:

Company: Jonathan Levi Architects

Date: 11/5/2024

Printed Name: Carol Harris

LeftField, LLC

DocuSigned by:  
Lynn Stapleton

368F4375FA59451...

By: OPM

Title:

Company: LeftField

Date: 11/5/2024

Printed Name: Lynn Stapleton

Town of Brookline

DocuSigned by:  
Lap Yan

F2590000047DD485...

By: Director of Capital Construction

Title:

Company: Town Of Brookline BLDG Dept

Date: 11/5/2024

Printed Name: Lap Yan



Date: 10/22/2024  
Revised:

Project Name: Michael Driscoll School  
Project No: J08864

Change Summary

Change Number:	OS-441
Description:	RFI 873- Gas Line at Tree Pits

Bid Package / Scope of Work	Subcontractor	Cost
02A Abatement / Demolition	American Environmental	\$0.00
03A Concrete	Marguerite Concrete, Inc.	\$0.00
05A Structural Steel	SuperMetal Structures Inc.	\$0.00
06A Millwork	Polybois	\$0.00
07C Metal Panels	Salem Glass Company	\$0.00
07D Spray Fireproofing	Ricmor Construction, Inc.	\$0.00
08A Storefront	Salem Glass Company	\$0.00
08C Doors, Frames, and Hardware	Kamco Supply Corp. of Boston	\$0.00
09A Drywall & General Trades	Central Ceilings, Inc.	\$0.00
09F Wood Athletic Flooring	JJ Curran	\$0.00
09G Resinous Floors	Stonhard	\$0.00
09H Carpeting	Capital Carpet & Flooring Specialists	\$0.00
10A Specialties	Managanaro	\$0.00
10B Signage	Metro Signs	\$0.00
10C Overhead Doors	Baron	\$0.00
11A Theater Lighting	Barbazon	\$0.00
11B Gym Equipment and Bleachers	The Pappas Co.	\$0.00
11C Food Service Equipment	Kitteridge Equipment Company, Inc.	\$0.00
12B Window Treatments	Walker Specialties	\$0.00
31A Site Enabling	J. Derenzo Co.	\$3,417.00
32A Landscaping	Brightview	\$0.00
Subguard Insurance (CDI)	1.20%	\$41.00
Subcontractor Total		\$3,458.00

Bid Package / Scope of Work	Trade Contractor	Cost
04A Masonry	Fernandes Masonry, Inc.	\$0.00
05B Miscellaneous & Ornamental Iron	United Steel, Inc.	\$0.00
07A Waterproofing and Caulking	Armani Restoration, Inc.	\$0.00
07B Roofing and Flashing	J.D. Rivet & Co. Inc.	\$0.00
08B Glass and Glazing	Kapiloff's Glass, Inc.	\$0.00
09B Resilient Flooring	CJM Services, Inc.	\$0.00
09C Tile	Pavillion Floors, Inc.	\$0.00
09D Painting	Color Concepts Inc.	\$0.00
09E Acoustical Ceiling Tile	The Cheviot Corporation	\$0.00
14A Elevator	Delta Elevator Service Corp.	\$0.00
21A Fire Protection	Johnson Controls Fire Protection LP	\$0.00
22A Plumbing Enabling	Patrick J. Kennedy & Sons, Inc.	\$0.00
23A HVAC	Patrick J. Kennedy & Sons, Inc.	\$0.00
26A Electrical	Wayne J Griffin Electric, Inc.	\$0.00
Bond (included in above cost)		
Trade Contractor Total		\$0.00

Subcontractor/Trade Contractor Total	-	\$3,458.00
General Conditions		\$0.00
CM Bond	0.600%	\$21.00
Total CCIP	2.750%	\$98.00
Fee	5.00%	\$179.00
TOTAL		\$3,756.00





338 HOWARD ST. | BROCKTON, MA | 02302

October 9, 2024

**Gilbane Building Company**

10 Channel Center St.  
Boston, MA 02210

Attn: Douglas Murphy, Project Manager  
Project: Michael Driscoll School – Brookline, MA  
Re: JDC PCO 39 – RFI873 Tree Pit Relocation

William,

J. Derenzo Co. proposes to perform the scope detailed herein, based on the stated qualifications, inclusions, and exclusions, for a lump sum price of **\$3,416.85**

A detailed breakdown of change in scope referenced in this cover sheet is enclosed.

**Qualifications:**

- RFQ\_OS-429 RFI 856- Sidewalk Spot Grade Conflict Issued 6/27/2024 by Jonathon Levi Architects

**Inclusions:**

- Sawcut & dispose of concrete and excavation 36" for (1) relocated tree pit

**Exclusions:**

- Premium Time – nights, weekends, holidays, etc.
- Restoration of concrete sidewalks
- Import of aggregate materials
- Furnish/Installation of tree boxes
- Utility Relocation
- Contaminated Soils removal/disposal
- Winter Conditions

If you have any questions concerning this proposal, please do not hesitate to contact me using the information listed below.

Respectfully,  
J. DERENZO CO.

*Christian Rivera*

Christian Rivera  
Project Manager  
617-272-0240  
[crivera@jderenzo.com](mailto:crivera@jderenzo.com)

Proposal

From:	J Derenzo Co	Project:	21018 PCO39 RFI873 TREE PIT
	338 Howard Street		RELOCATION
	Brockton, MA 02302 USA	Description:	
	Phone: (508) 427-6441		

ITEM / DESCRIPTION	BID QTY	U/M	UNIT BID	AMOUNT
5 Relocation of Tree Pit	1.000	LS	\$3,416.85	\$3,416.85
			TOTAL BID:	\$3,416.85

PROJECT : 21018 PCO39 RFI873

ITEM SHEET COSTS  
AS SHOWN

Item:	5	Unit of Measure:	LS
Description:	Relocation of Tree Pit	Bid Quantity:	1.00
Cost Code:		Take-off Quantity:	1.000
Production:	DAYS	Total Man-Hours:	5.00
Hours per Day:	8	Man-Hours per Unit:	5.0000
Alternate:		Units / MH:	0.2000

Item Production

ITEM#	DESCRIPTION	U/M	QTY	Time Units	Time Req'd
5	Relocation of Tree Pit	LS	1.00	4.00 (D)	0.25

Cost Detail for Item 5

R	Code	Description	QTY	U/M	Factor	Rate	Cost
L	JDC-FOR	FOREMAN	0.50		0.25	831.60	103.95
L	JDC-LAB	LABORER	2.00		0.25	825.12	412.56
E	WRITEIN	CAT320 Rubber Tire Excavator w/Operator	1.00		0.25	3,130.00	782.50
E	WRITEIN	6 Wheel Dump Truck	1.00		0.50	1,573.68	786.84
S	WRITEIN	Soil Disposal as Clean	5.00	TON	1.00	12.00	60.00
S	WRITEIN	Sawcutter (1/2 Day)	1.00	EA	1.00	875.00	875.00
S	WRITEIN	Concrete Disposal	1.00	LD	1.00	275.00	275.00
Item Unit Cost:			3,295.85	Item Total Cost:			3,295.85

	Labor	Equipment	Rental Eq	Material	Subcontract	Other
Total:	516.51	1,569.34	0.00	0.00	1,210.00	0.00
Unit:	516.51	1,569.34	0.00	0.00	1,210.00	0.00

Bid Data for Item: 5

	Quantity	Bid Unit	Bid Amount	Total Cost	Prof & Ovhd	Windfall
Bid Qty:	1.00	3,416.85	3,416.85	3,295.85	121.00	
Take-off Qty:	1.00	3,416.85	3,416.85	3,295.85	121.00	0.00



Request for Quotation  
(RFQ)



Project Name: Brookline - Driscoll  
School  
Gilbane Project No.: J08864.000

PCI: OS-00441  
  
Due Date: 10/19/2024

Attention:  
To: J. Derenzo Company  
338 Howard Street  
  
Brockton  
MA  
02302  
Contract: J08864.000-0020

Date Issued: 10/09/2024

PCI Subject: RFI 873.2- Gas Line at Tree Pits  
Scope:

Sitework  
Attachments:

Number	Title	Change Date	Revision
--------	-------	-------------	----------

☐ Do Not Proceed, submit quotation only      ☐ Submittal(s) required      ☐ Proceed with the work & submit quotation

Return this request with your quotation noted below and attach all detailed documentation for the change outlined above. Your quotation will not be considered valid unless detailed documentation is included. Failure to comply will result in payment delays.

Section to be Completed by the Trade Contractor

☐ No Change to contract price or schedule

The following pricing is for the changes outlined above. Zero (\$0) dollars have been entered for changes that have no cost impact.

Job	Phase Code	Description	Quoted Amount	Diversity Participation
J08864.000	01.31A.311000.X	Sitework	\$ ..	

This change increases/(decreases) our Disadvantaged Business Enterprise participation by the below amounts which are included in the above quotation:

Phase Code	Company	(Minority) MBE	(Women) WBE	(Small) SBE	Other	Disadvantaged DBE
01.31A.311000.X	J. Derenzo Company	..... %	..... %	..... %	..... %	..... %

The above changes will necessitate additional days extension of the original contract completion date by

..... days  
Note that any days extension requested will require substantiating documentation to support the request for time including demonstration of

**Upload Your Supporting Documentation Here**

\*

Signatures

Gilbane Building Company

Gilbane Building Company

Signed: 10/9/2024 9:41:19 AM Eastern Standard Time - By: Robert Hannula, (Project Engineer II )

Gilbane Building Company: 10.41.174.130

J. Derenzo Company

By: \_\_\_\_\_

Title: \_\_\_\_\_

Company: \_\_\_\_\_

Date: \_\_\_\_\_

Printed Name: \_\_\_\_\_



RFI #873.1

Gilbane Building Company  
10 Channel Center Street  
Suite 100  
Boston, Massachusetts 02210  
Phone: (617) 478-2981

Project: J08864.000 - Michael Driscoll School - Brookline  
725 Washington Street  
Brookline, Massachusetts 02446

Gas Line at Tree Pits

TO:	Mark Warner (Jonathan Levi Architects LLC) James Macheek (Jonathan Levi Architects LLC) Eric Wilhelmsen (CDW Consultants, Inc.) Carol Harris (Jonathan Levi Architects LLC) Bryan Jereb (Halvorson Design Partnership)	FROM:	Lucas Seiferth (Gilbane Building Company)
		STATUS:	Open
		DUE DATE:	09/15/2024
		COST CODE:	
DATE INITIATED:	09/10/2024	SCHEDULE IMPACT:	TBD
LOCATION:		SPEC SECTION:	
PROJECT STAGE:		REFERENCE:	
SUB JOB:			
COST IMPACT:	Yes (Unknown)		
DRAWING NUMBER:			
LINKED DRAWINGS:			
RECEIVED FROM:	Lucas Seiferth (Gilbane Building Company)		
COPIES TO:	Andrew Deschenes (LEFTFIELD, LLC), Robert Hannula (Gilbane Building Company), Doug Murphy (Gilbane Building Company), Steve Raposa (J. Derenzo Company), Christian Rivera (J. Derenzo Company), Lucas Seiferth (Gilbane Building Company), Vincent Shanley (BrightView landscape Development, Inc.), Kimkya Turner (BrightView landscape Development, Inc.), Anatoliy vlasevich (Marguerite Concrete Contractors, Inc)		

Question from Lucas Seiferth (Gilbane Building Company) at 09:18 AM on 09/10/2024

As discussed in the field on 9/10/24, the tree pits are to be deleted or relocated back to avoid the gas line and to align with the other tree pits. As the tree pits are already dug, the filling in of these is owned, but re-digging the new pits and changing form work would be a change. Please confirm this is acceptable. Additionally, please confirm deleting the two tree pits is acceptable with Tom Brady (Town of Brookline Tree Warden).

Attachments:  
[Gas Line at Tree Pits\[1\].pdf](#)

Awaiting an Official Response

All Replies:

It is acceptable to the design to do the remedial work as shown on the sketches in this response or to eliminate one or both of the trees. It is our understanding that there is one abutter with particular interest in having a tree planted in the sightline of their property. The decision should go to the Town of Brookline.

Mark Warner JLA 9/10/2024

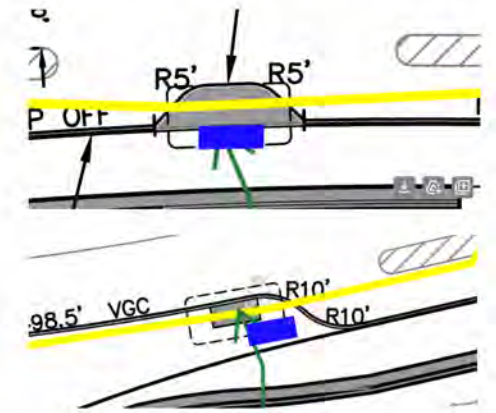

If the information provided in the response to this RFI constitutes a change in contract price or time, the trade contractor shall not proceed with this work unless authorized to do so by the Construction Manager in writing. The trade contractor shall provide the Construction Manager written notice within five (5) working days from receipt of this Request for Information that this RFI constitutes a change. Should no change be required, a no cost change will be issued to you incorporating this RFI into your contract.

BY DATE COPIES TO



# EXISTING CONDITIONS/SURVEY NOTES:

- EXISTING CONDITIONS ARE BASED ON A SURVEY PREPARED BY HANCOCK ASSOCIATES, 315 ELM STREET, MARLBOROUGH, MA 01752, "ENTITLED EXISTING CONDITIONS PLAN OF LAND IN BROOKLINE, MA", SHEET EC, PROJECT NO 21770, REVISED 04/22/20. THE PROPERTY LINES, BEARINGS AND DISTANCES SHOWN ON THE PLANS ARE APPROXIMATE ONLY, COMPILED FROM PLANS AND RECORDS OF RECORD, MASS GIS PARCEL LINES, AND ASSESSOR MAP INFORMATION AND IS NOT TO BE CONSIDERED A PROPERTY LINE BOUNDARY SURVEY. A PROPERTY BOUNDARY SURVEY HAS NOT BEEN CONDUCTED. ALL PROPERTY LINES SHOULD BE VERIFIED.
- ELEVATIONS SHOWN HEREON REFER TO TOWN OF BROOKLINE DATUM.
- THE SITE IS NOT WITHIN A 100-YEAR FLOOD PLAIN, AS SHOWN OF FLOOD INSURANCE RATE MAP, NUMBER 25021C0034E, EFFECTIVE DATE JULY 17, 2012.

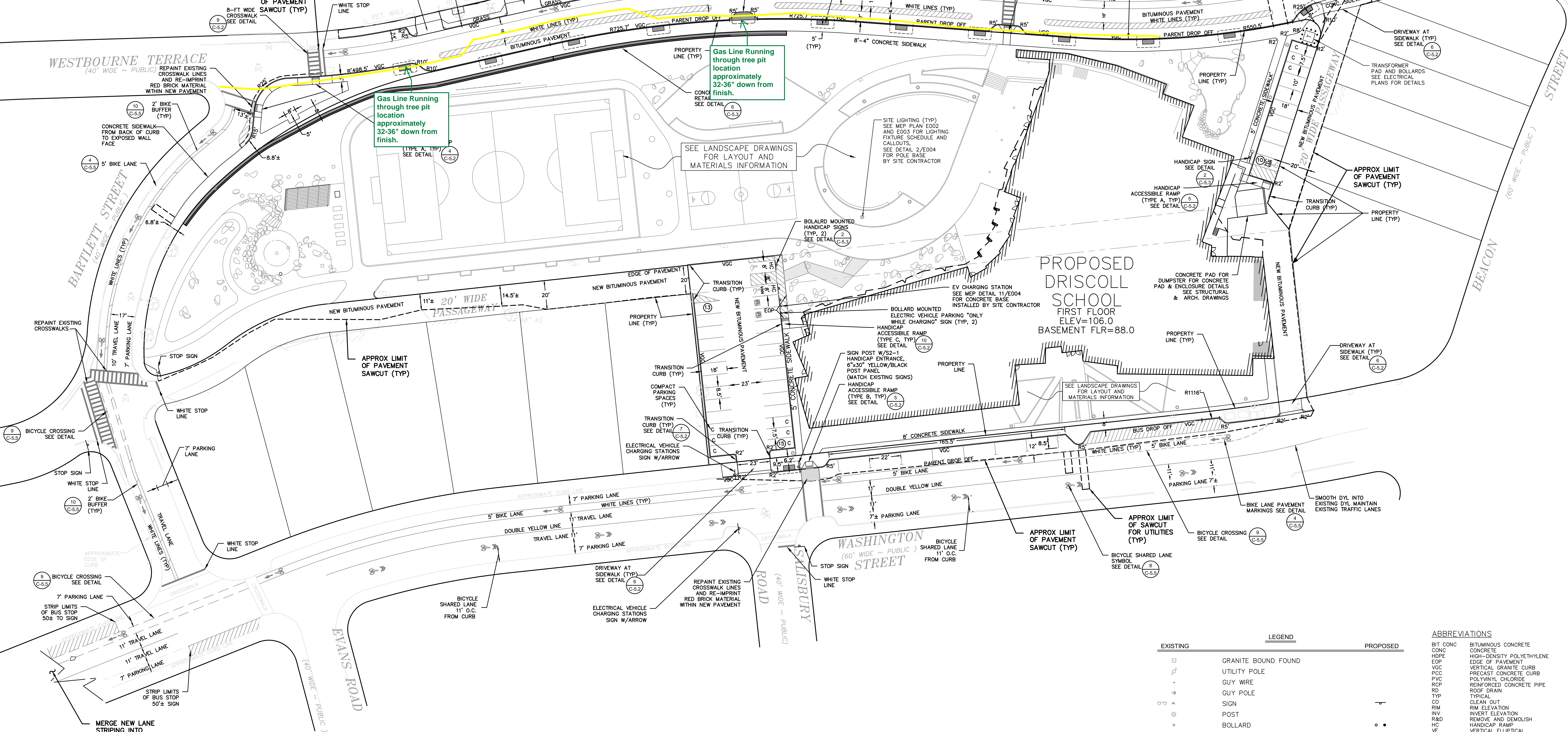

## LAYOUT AND MATERIALS NOTES

- ALL LINES AND DIMENSIONS ARE PARALLEL OR PERPENDICULAR TO THE LINES FROM WHICH THEY ARE MEASURED UNLESS OTHERWISE INDICATED.
- REFER TO MEP PLANS FOR SITE LIGHTING LOCATIONS AND DETAILS.
- CONTRACTOR SHALL REPORT SIGNIFICANT CONFLICTS TO THE OWNER AND THE ENGINEER FOR RESOLUTION.
- DIMENSIONS OF PARKING SPACES AND DRIVEWAYS ARE FROM FACE OF CURB TO FACE OF CURB. STANDARD PARKING SPACES ARE 8.5'x18'.
- DIMENSIONS FROM BUILDING ARE FROM FACE OF BUILDING. CONTRACTOR SHALL VERIFY ALL CONDITIONS IN THE FIELD AND REPORT ANY DISCREPANCIES TO THE ENGINEER. THE CONTRACTOR SHALL STAKE OUT BUILDING FROM THE LATEST ARCHITECTURAL DRAWINGS.
- THE CONTRACTOR SHALL NOTIFY THE ENGINEER OF ANY DISCREPANCIES BETWEEN SITE PLAN DIMENSIONS AND BUILDING PLANS BEFORE PROCEEDING WITH ANY PORTION OF SITE WORK WHICH MAY BE AFFECTED SO THAT PROPER ADJUSTMENTS TO THE SITE LAYOUT CAN BE MADE IF NECESSARY.
- SEE ARCHITECTURAL DRAWINGS FOR EXACT BUILDING DIMENSIONS AND ALL DETAILS CONTIGUOUS TO THE BUILDING, LIGHTING, ENTRANCES, DRIVEWAY PADS, LOADING DOCK DETAILS, ETC.
- ACCESSIBLE RAMPS SHALL BE PER MASSACHUSETTS STATE CODE AND THE AMERICANS WITH DISABILITIES ACT (ADA) ACCESSIBILITY GUIDELINES (WHICHEVER IS MORE STRINGENT).
- EACH HANDICAP PARKING SPACE SHALL BE PROVIDED WITH A SIGN SIX (6) FEET IN HEIGHT LOCATED AT THE BACK OF THE CURB. THE SIGN SHALL CONTAIN THE INTERNATIONAL SYMBOL OF ACCESSIBILITY AS DESCRIBED IN THE AMERICANS WITH DISABILITIES ACT, PUBLIC LAW 101-336, (SEE DETAILS).
- PROTECT EXISTING PROPERTY MONUMENTS AND ADJUTING PROPERTIES DURING CONSTRUCTION ACTIVITIES.
- ALL SITE CONSTRUCTION SHALL BE IN CONFORMANCE WITH THE MASSACHUSETTS DEPARTMENT OF TRANSPORTATION STANDARD SPECIFICATIONS FOR HIGHWAYS AND BRIDGES, AND THE TOWN OF BROOKLINE PUBLIC WORKS. SEE THE FOLLOWING WEB SITES FOR ADDITIONAL INFORMATION: <https://www.mass.gov/lists/construction-specifications> AND <https://www.brookline.gov/436/Public-Works>
- THE CONTRACTOR SHALL BE RESPONSIBLE FOR THE LEGAL REMOVAL AND DISPOSAL OF ALL DEBRIS FROM THE SITE AND AS MAY BE DIRECTED BY THE A/E.
- ALL FENCING AND GATES SHALL BE INSTALLED IN ACCORDANCE WITH THE MANUFACTURERS DIRECTION, SEE LA PLANS FOR DETAILS.
- THE SITE CONTRACTOR SHALL SAW OUT AND MATCH ALL EXISTING ROAD PAVEMENT AS REQUIRED TO SET NEW CURBING AND CONSTRUCT NEW UTILITIES IN THE STREET.
- SEE LANDSCAPE PLANS FOR ALL PLANTING INFORMATION AS WELL AS ADDITIONAL LAYOUT AND MATERIAL INFORMATION.
- SEE DEMOLITION SHEET C-1.0 AND DETAIL SHEET C-5.0 FOR EROSION CONTROL NOTES.
- NOT ALL PARKING METERS, SCHOOLS SIGNS AND STREETS LIGHTS TO BE RESET MAY BE SHOWN ON THIS LAYOUT AND MATERIALS PLAN. SEE SHEET C-5.6 FOR LOCATIONS OF SCHOOL SIGNS, AND ADDITIONAL PAVEMENT MARKING TO BE RESET OR INSTALLED AS NEW. RELOCATED PARKING METERS, STREET LIGHTS, TO BE COORDINATED WITH THE TOWN.
- WHERE CURBING ABRUPTLY ENDS, PROVIDE A TRANSITION CURB TO A FLUSH CONDITION WITH THE PROPOSED SURFACE/GRADES, SEE DETAIL 8/C-5.2.
- EXISTING CROSSWALKS TO BE REPAINTED ON BARTLETT STREET AND ON WASHINGTON STREET, SHOULD BE DONE AFTER THE DEMOLITION OF THE EXISTING SCHOOL.
- PAVEMENT MARKINGS NOT BEING REPAINTED IN PLACE, OR ARE IN A DIFFERENT LOCATION THAN THE NEW PROPOSED MARKINGS SHALL BE REMOVED BY GRINDING OR WATER BLASTING. COVERING UP OR BLACKING OUT EXISTING MARKINGS SHALL ONLY BE ALLOWED IF APPROVED BY THE OWNER'S PROJECT MANAGER OR THE TOWN OF BROOKLINE.

LEGEND	
EXISTING	PROPOSED

ABBREVIATIONS	
BIT CONC	BITUMINOUS CONCRETE
CONC	CONCRETE
HDPE	HIGH-DENSITY POLYETHYLENE
EOP	EDGE OF PAVEMENT
VGC	VERTICAL GRANITE CURB
PCC	PRECAST CONCRETE CURB
PVC	POLYVINYL CHLORIDE
RCP	REINFORCED CONCRETE PIPE
RD	ROOF DRAIN
TYP	TYPICAL
CO	CLEAN OUT
RIM	RIM ELEVATION
INV	INVERT ELEVATION
R&D	REMOVE AND DEMOLISH
HC	HANDICAP RAMP
VE	VERTICAL ELLIPTICAL
TC/B	TOP OF CURB/BOTTOM OF CURB
TW	TOP OF WALL
LA	LANDSCAPE ARCHITECT
SSD	SUB SOIL DRAIN
UD	UNDER DRAIN / SUB DRAIN

## GRAPHIC SCALE

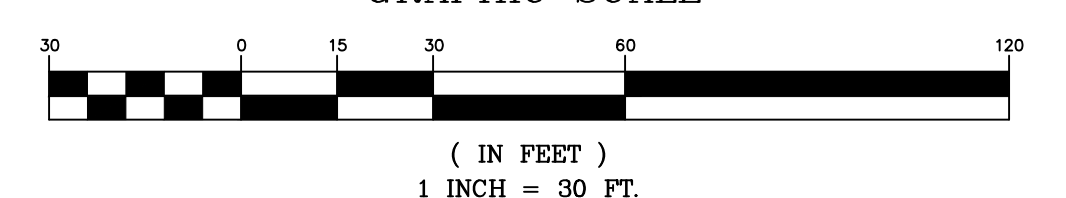

**Jonathan Levi Architects**  
266 beacon street  
boston ma 02116  
tel 617 437 9458  
fax 617 437 1945

**CDW** CDW CONSULTANTS, INC.  
CIVIL & ENVIRONMENTAL ENGINEERS  
8 HURON DRIVE  
NATICK, MA 01760  
TEL: (978) 675-2657 FAX: (978) 675-8817  
WWW.CDWCONSULTANTS.COM

## DRISCOLL SCHOOL

### PROJECT STATUS

Contract Documents  
4/16/2021

### REVISIONS

No.	Date	Description

DRAWING NAME  
**LAYOUT & MATERIALS PLAN**

PROJECT NO.

DRAWING NO.

**C-2.0**

SITE PLAN #2021-18



Gilbane Building Company  
Authorization To Proceed



**CONTRACT FOR:** Brookline - Driscoll School  
**OWNER:** Town of Brookline  
**ADDRESS:** 333 Washington Street  
Brookline, MA 02445

**PROJECT NUMBER:** J08864.000  
**ATP NO:** ATP-0449  
**ATP VERSION:** 0  
**DATE OF ISSUANCE:**  
**SUBMITTED BY:** Gilbane Building Company

**ARCHITECT:** Jonathan Levi Architects LLC, Mark Warner

**ALTERNATE  
TRACKING #:**

The Contract Documents are hereby amended to include the additional Work described below, which is outside of the current scope of the Work and constitutes a change.

*Upon Owner approval,* Gilbane Building Company *will proceed with the Work promptly.*

Costs as incurred are in addition to the current contract Sum and will be invoiced and paid on a monthly basis and identified as separate items within the requisition. Once final cost of the Work involved and change in Sum and Time (if any) are fully determined, it will be submitted for inclusion in a final Change Order adjusting the Contract Sum and/or Time.

**TITLE:**RFI 866- Exterior Water Line Valves

**DESCRIPTION:**This ATP represents the cost associated with providing the town standard gate valves, as noted in the responses to RFI 866, and not installing the shutoff valves shown on P005 and in the plumbing specs.

Attachments:

Number	Description:	PCI Number	Change Date	Revision
00000001	<a href="#">ATP-449 Backup.pdf</a>		10/29/2024	

The Following information is provided by Gilbane Building Company  
**Method of determining change in Contract:**

☐ Guaranteed Maximum Price ☐ Cost Plus Fee ☐ Unit Price ☐ Lump Sum  
☐ Other

**Change In Contract Sum**  
Dollar Amount: \$1,740.00

☐ Fixed ☐ Maximum ☐ Estimated ☐ Time and Material

**Change In Contract Time**  
Time (Days): TBD

☐ Fixed ☐ Maximum ☐ Estimated

Job	PCI No.	Description	Phase Code	SubContractor	Amount
J08864.000	OS-00438	Plumbing	01.22A.220000.TC	Patrick J Kennedy & Sons Inc	\$1,601.00

Job	PCI No.	Description	Phase Code	SubContractor	Amount
J08864.000	OS-00438	Gen & Excess Liability Insurance	99.970.950050.Z		\$46.00
J08864.000	OS-00438	Performance & Payment Bond	99.970.997000.Z		\$10.00
J08864.000	OS-00438	Subcontractor Default Insurance	99.975.996000.Z		\$.00
J08864.000	OS-00438	Fee	99.999.999000.Z		\$83.00
TOTAL FOR PCI No. OS-00438					\$1,740.00

Submitted Amt: \$1,740.00

Gilbane Building Company

Gilbane Building Company

Signed: 10/29/2024 10:46:52 AM Eastern Standard Time - By:  
Douglas Murphy (Project Executive )

Gilbane Building Company: 10.129.22.166

Jonathan Levi Architects LLC

DocuSigned by:  
Carol Harris

By: 

AF1EA2FE13C443D...

Title: Project Manager

Company: Jonathan Levi Architects

Date: 11/5/2024

Printed Name: Carol Harris

LeftField, LLC

DocuSigned by:  
Lynn Stapleton

By: 

368F4379FA56451...

Title: OPM

Company: LeftField

Date: 11/5/2024

Printed Name: Lynn Stapleton

Town of Brookline

DocuSigned by:  
Lap Yan

By: 

F259800347DD4B5...

Title: Director of Capital Construction

Company: Town Of Brookline BLDG Dept

Date: 11/5/2024

Printed Name: Lap Yan



Date: 10/29/2024  
Revised:

Project Name: Michael Driscoll School  
Project No: J08864

Change Summary

Change Number:	OS-438
Description:	RFI 866- Exterior Water Line Valves

Bid Package / Scope of Work	Subcontractor	Cost
02A Abatement / Demolition	American Environmental	\$0.00
03A Concrete	Marguerite Concrete, Inc.	\$0.00
05A Structural Steel	SuperMetal Structures Inc.	\$0.00
06A Millwork	Polybois	\$0.00
07C Metal Panels	Salem Glass Company	\$0.00
07D Spray Fireproofing	Ricmor Construction, Inc.	\$0.00
08A Storefront	Salem Glass Company	\$0.00
08C Doors, Frames, and Hardware	Kamco Supply Corp. of Boston	\$0.00
09A Drywall & General Trades	Central Ceilings, Inc.	\$0.00
09F Wood Athletic Flooring	JJ Curran	\$0.00
09G Resinous Floors	Stonhard	\$0.00
09H Carpeting	Capital Carpet & Flooring Specialists	\$0.00
10A Specialties	Managanaro	\$0.00
10B Signage	Metro Signs	\$0.00
10C Overhead Doors	Baron	\$0.00
11A Theater Lighting	Barbazon	\$0.00
11B Gym Equipment and Bleachers	The Pappas Co.	\$0.00
11C Food Service Equipment	Kitteridge Equipment Company, Inc.	\$0.00
12B Window Treatments	Walker Specialties	\$0.00
31A Site Enabling	J. Derenzo Co.	\$0.00
32A Landscaping	Brightview	\$0.00
Subguard Insurance (CDI)	1.20%	\$0.00
Subcontractor Total		\$0.00

Bid Package / Scope of Work	Trade Contractor	Cost
04A Masonry	Fernandes Masonry, Inc.	\$0.00
05B Miscellaneous & Ornamental Iron	United Steel, Inc.	\$0.00
07A Waterproofing and Caulking	Armani Restoration, Inc.	\$0.00
07B Roofing and Flashing	J.D. Rivet & Co. Inc.	\$0.00
08B Glass and Glazing	Kapiloff's Glass, Inc.	\$0.00
09B Resilient Flooring	CJM Services, Inc.	\$0.00
09C Tile	Pavillion Floors, Inc.	\$0.00
09D Painting	Color Concepts Inc.	\$0.00
09E Acoustical Ceiling Tile	The Cheviot Corporation	\$0.00
14A Elevator	Delta Elevator Service Corp.	\$0.00
21A Fire Protection	Johnson Controls Fire Protection LP	\$0.00
22A Plumbing Enabling	Patrick J. Kennedy & Sons, Inc.	\$1,601.00
23A HVAC	Patrick J. Kennedy & Sons, Inc.	\$0.00
26A Electrical	Wayne J Griffin Electric, Inc.	\$0.00
Bond (included in above cost)		
Trade Contractor Total		\$1,601.00

Subcontractor/Trade Contractor Total	-	\$1,601.00
General Conditions		\$0.00
CM Bond	0.600%	\$10.00
Total CCIP	2.750%	\$46.00
Fee	5.00%	\$83.00
TOTAL		\$1,740.00



Patrick J. Kennedy &amp; Sons, Inc.

MECHANICAL CONTRACTORS

39 Gibson Street

Boston, MA 02122-1222

Ph : (617)265-5535

**PROPOSED CHANGE ORDER****Number:** PCO-022**Date:** 8/12/24**Phone:****Job:** 2021-04 Driscoll School Plumbing

**To:** Douglas Murphy  
 Gilbane Building Co  
 10 Channel Center St  
 Suite 100

**Description:** RFI-866 Response

Source: RFI # 866

Additional costs associated with providing valves specified in section 33 10 00 in lieu of valves in plumbing section as noted in RFI-866 response.

**Notes:**

- All work during normal working hours
- Change specific to valve change; if final location of equipment is changing this will need to be reviewed once locations provided.

Description	Quantity	Unit	Unit Price	Price
Material	1.00	ls	\$1,435.00	\$1,435.00
			Subtotal:	\$1,435.00
Material Markup	\$1,435.00	10.00%		\$143.50
Bond Cost	\$1,578.50	1.44%		\$22.73
	\$1,435.00	-0.02%		\$-0.23
			<b>Total:</b>	<b>\$1,601.00</b>

Please note that Patrick J. Kennedy & Sons, Inc. will require an extra 0 days.

If you have any questions, please contact me at 617-446-8000.

Submitted by: Raymond Hanley  
 Patrick J. Kennedy & Sons, Inc

Approved by: \_\_\_\_\_  
 Date: \_\_\_\_\_





METROPOLITAN PIPE & SUPPLY  
30 INNERBELT ROAD  
UNIT 1

**1-800-MetPipe**  
www.MetPipe.com

**Bid**

BID DATE	BID NUMBER
08/07/24	S3968272
ORDER TO: METROPOLITAN PIPE & SUPPLY 30 INNERBELT ROAD UNIT 1 SOMERVILLE MA 02143	PAGE NO:  1

Printed: 09:33:25 12 AUG 2024



SOLD TO:  
PATRICK J KENNEDY & SONS  
39 GIBSON STREET  
DORCHESTER, MA 02122

SHIP TO:  
PATRICK J KENNEDY & SONS  
39 GIBSON STREET  
DORCHESTER, MA 02122  
Phone #: 617-536-9674

EXP DATE	CUSTOMER ORDER NUMBER		RELEASE NUMBER	ORDERED BY	
09/06/24	CURB BOXES			RAY	
WRITER		SALESPERSON	SHIP VIA	BRANCH S/P	FREIGHT
Dennis P. Sullivan x22		Dennis P. Sullivan x	OT OUR TRUCK	1/1	Billable
ORDER QTY	SHIP QTY	DESCRIPTION		Net Price	Ext Price
		***** Shipping Instructions *****			
		*		*	
		*****			
1ea	-	FGB44-777Q-NL 2in FORD BALL VALVE QUICK JOINT CTS LEAD FREE Loc: (P) Pn: 1022405		1030.000ea	1030.00
1ea	-	94VLF-108-01A 2in LF PRESS BALL VALVE FULL PORT BRASS CONBRACO Loc: (P) M1-S06-0201A Pn: 1071619		165.000ea	165.00
		Subtotal -----			1195.00
		***			
2ea	-	FGB44-444Q-NL 1in FORD BALL VALVE QUICK JOINT CTS LEAD FREE Loc: (P) Pn: 1022402		330.000ea	660.00
2ea	-	94VLF-105-01A 1in LF PRESS BALL VALVE FULL PORT BRASS CONBRACO Loc: (P) M1-U12-0101A Pn: 1071616		45.000ea	90.00
		Subtotal -----			750.00
		*****			
		*****			
		Subtotal:			1945.00
		Tax:			0.00
		Order Total:			1945.00

Due to pricing uncertainty in the marketplace, all quoted prices are subject to change daily. Special material is non-cancelable.

\*\* Reprint \*\* Reprint \*\* Reprint \*\*



SUBMITTAL INFORMATION

Ball Valve Curb Stop - (B44-xxx-Q-NL style)

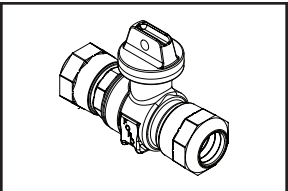

QUICK JOINT FOR COPPER OR PLASTIC TUBING (CTS) INLET AND OUTLET

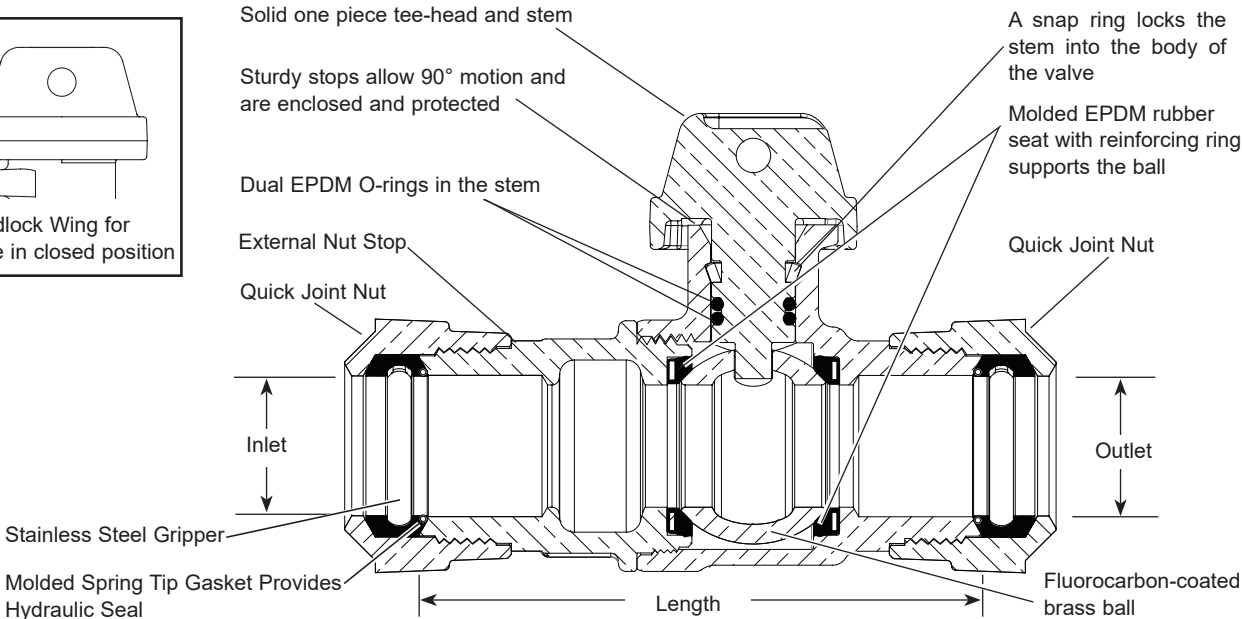
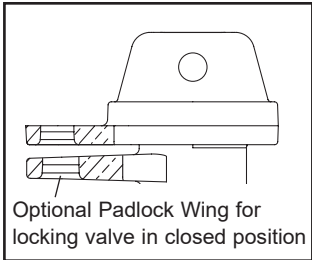

Due to design variations related to sizing, items may differ from images above.

VALVE SIZE	INLET SIZE	OUTLET SIZE	LENGTH	APPROX. Wt. LBS	PART NUMBER	✓ SUBMITTED ITEM(S)
3/4"	3/4"	3/4"	3-11/16"	2.2	B44-333-Q-NL	
3/4"	1"	3/4"	4"	2.6	B44-343-Q-NL	
3/4"	1"	1"	4-27/32"	3.2	B44-344-Q-NL	
1"	1"	1"	4-5/16"	3.2	B44-444-Q-NL	
1-1/4"	1-1/4"	1-1/4"	6-11/32"	5.6	B44-555-Q-NL	
1-1/2"	1-1/2"	1-1/2"	5-23/32"	6.3	B44-666-Q-NL	
2"	2"	2"	6-9/16"	9.4	B44-777-Q-NL	

**Note:** Ford recommends insert stiffeners when using plastic pipe or tubing.

FEATURES

- All brass that comes in contact with potable water conforms to AWWA Standard C800 (ASTM B584, UNS C89833)
- The product has the letters "NL" cast into the main body for lead-free identification
- Certified to NSF/ANSI/CAN Standard 61 and NSF/ANSI/CAN Standard 372 where applicable
- Brass components that do not come in contact with potable water conform to AWWA Standard C800 (ASTM B62 and ASTM B584, UNS C83600, 85-5-5-5)
- Valve is non-directional and is watertight with flow in either direction
- Ends are integral or secured with adhesive to prevent unintentional disassembly
- Hole for attaching curb box rod or handle is provided in tee-head
- 300 PSI working pressure

**Optional Padlock Wing** for locking valve in closed position. Insert "W" into part number

The Ford Meter Box Company considers the information in this submittal form to be correct at the time of publication. Item and option availability, including specifications, are subject to change without notice. Please verify that your product information is current. Our standard warranty applies.



**The Ford Meter Box Company, Inc.**  
P.O. Box 443, Wabash, Indiana U.S.A. 46992-0443  
Phone: 260-563-3171 / Fax: 800-826-3487  
Overseas Fax: 260-563-0167  
www.fordmeterbox.com

11/09/23

Submitted By:



Gilbane Building Company  
10 Channel Center Street  
Suite 100  
Boston, Massachusetts 02210  
Phone: (617) 478-2981

Project: J08864.000 - Michael Driscoll School - Brookline  
725 Washington Street  
Brookline, Massachusetts 02446

Water Line Locations and Clarifications

TO:	Mark Warner (Jonathan Levi Architects LLC) James Machek (Jonathan Levi Architects LLC) Carol Harris (Jonathan Levi Architects LLC) Bryan Jereb (Halvorson Design Partnership)	FROM:	Lucas Seiferth (Gilbane Building Company)
DATE INITIATED:	07/25/2024	STATUS:	Open
LOCATION:		DUE DATE:	07/30/2024
PROJECT STAGE:		COST CODE:	
SUB JOB:		SCHEDULE IMPACT:	
COST IMPACT:		SPEC SECTION:	
DRAWING NUMBER:		REFERENCE:	
LINKED DRAWINGS:			
RECEIVED FROM:	Ray Hanley (Patrick J. Kennedy & Sons, Inc.)		
COPIES TO:	Andrew Deschenes (LEFTFIELD, LLC), Ray Hanley (Patrick J. Kennedy & Sons, Inc.), Robert Hannula (Gilbane Building Company), Wayne Mazza (Patrick J. Kennedy & Sons, Inc.), Doug Murphy (Gilbane Building Company), Julio pinhancos (J. Derenzo Company), Steve Raposa (J. Derenzo Company), Lucas Seiferth (Gilbane Building Company)		

Question from Lucas Seiferth (Gilbane Building Company) at 03:04 PM on 07/25/2024

Please provide locations and clarifications for the following plumbing items for the water lines in phase 2:

- See P005. Please provide dimension location for the recessed yard hydrant box. Please provide layout.
- L606 detail Notes that the water line inlet is to be a 2 degree slope back to water supply. Please review and confirm this is required with such a significant pipe run.
- P005 shows gate valves for the drinking fountain, splash pad and yard hydrant. Please confirm required valve for these locations. Curb stop shut offs are shown on C-4.0. Additionally please confirm location of the valves to be determined in field during installation or provide specific locations.

Awaiting an Official Response

Refer to responses below. Field determination of locations is acceptable. Provide graphic mark up for general locations.

1. The recessed yard hydrant box should be moved closer to the fence line.

Per GGD:

2. A 2% slope is not required. Slope back to the building to prevent sagging of pipe.

Per CDW:

3. In general terms a curb box/valve generally refers to the box/cover that allows access to the valve. The specific valve per Spec 33 10 00,2.7 are gate valves, and standard town requirements.

Mark Warner 8/7/24

If the information provided in the response to this RFI constitutes a change in contract price or time, the trade contractor shall not proceed with this work unless authorized to do so by the Construction Manager in writing. The trade contractor shall provide the Construction Manager written notice within five (5) working days from receipt of this Request for Information that this RFI constitutes a change. Should no change be required, a no cost change will be issued to you incorporating this RFI into your contract.

BY \_\_\_\_\_ DATE \_\_\_\_\_ COPIES TO \_\_\_\_\_